



Adamo – the perfect companion to every adventure

- Available in three versatile layouts all under 7.5 metres long and with an MPTLM of 3,500 kgs or less making them suitable to drive by anyone holding a full UK driving licence, without the need for a B + E entitlement
- All models are built on the universally popular Ford Transit platform and are powered by the latest 2.0 litre 160bhp engine complete with automatic gearbox
- Crash-tested vehicle design, including twin Aguti rear travel seats maximises safety of all occupants when out on the open road
- Models come packed with intelligent design features including convertible 'Flexi-lounges', electrically operated drop down beds and ample garage storage space
- A fully specified Truma Combi programmable heating system combines with market leading insulation, courtesy of the Alu-Tech body shell to make the new Adamo a motorhome for all seasons
- Adamo provides customers with more motorhome for their money with a list of standard fit features normally only available as optional extras in comparable competitor products
- Models from the new Adamo line up will start arriving on Retailer forecourts from late September onwards



PRESS RELEASE

ISSUE DATE: 25/09/2020

EMBARGO DATE: 25/09/2020

REFERENCE NO: 200921

A motorhome created to allow you to get the most from the great outdoors, the new Bailey Adamo is the perfect companion to every adventure.

Available in a choice of three innovative layouts, Adamo has been developed to be as versatile as possible in order to cater for the broadest spectrum of potential new motorhome owners. All models are under 7.5 metres in length and have an MPTLM of 3,500kgs or under making them suitable to drive by anyone holding a full UK driving licence, without the need for a B + E entitlement.

Adamo 69-4

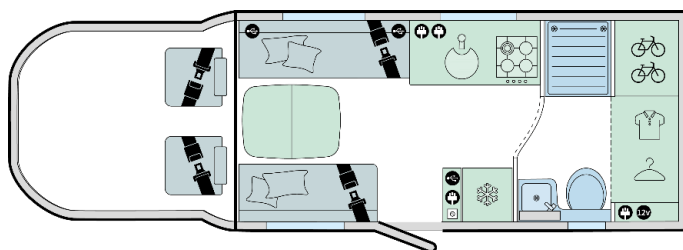

4-Berth with 2 or 4 travel seats, parallel front lounge with double drop down bed above, central kitchen, rear bathroom and end garage.

Adamo 75-4I

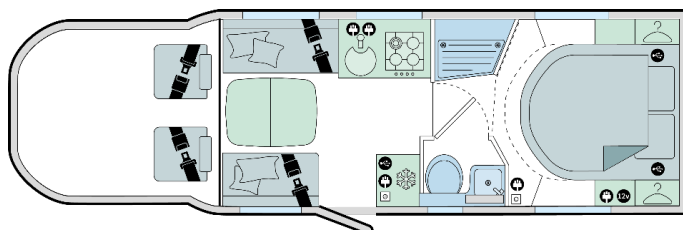

4-Berth with 2 or 4 travel seats, parallel front lounge, central kitchen and washroom, rear bedroom, with longitudinal double island bed and end garage.

Adamo 75-4DL

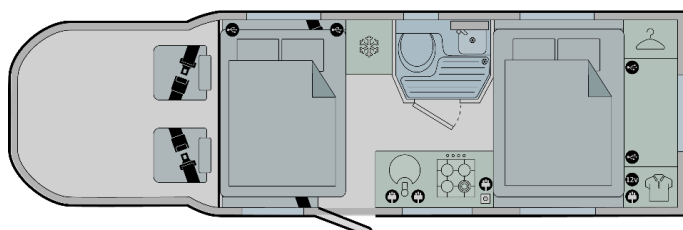



PRESS RELEASE

ISSUE DATE: 25/09/2020

EMBARGO DATE: 25/09/2020

REFERENCE NO: 200921

4-berth with 2 or 4 travel seats, parallel front lounge with double drop down bed above, central kitchen and washroom, rear U-shaped lounge with double drop down bed above and end garage.

Packed with intelligent design features, Adamo is the perfect mobile base from which to enjoy life's adventures. Each model, for example, has a versatile 'Flexi-lounge' which consists of twin parallel seats that can convert into Aguti travel seats to accommodate two extra passengers if required. These sit either side of a central floor mounted electric pedestal table large enough for four people to dine on in comfort.

Vehicles include sizeable garage storage space, complete with clever touches such as 230v and 12v power sockets, a blown air heating outlet and floor mounted lashing rings, which allow you to keep the outdoors separate from the indoors whilst on your travels. Certain layouts also feature three-position electrically-operated drop-down double beds which create additional living space during the day and provide flexible sleeping arrangements at night.

These motorhomes are built on a 'Metallic Silver' Ford Transit cab and chassis platform and are powered by the latest 2.0 litre 160 bhp engine complete with automatic gearbox to deliver the ultimate in driving pleasure. This fully specified cab includes a host of features to enhance on-the-road comfort including air conditioning, cruise control and fully adjustable Captain's seats with dual arm rests all as standard, while the factory-fit Dometic reversing camera with separate viewing screen allows you to manoeuvre your motorhome with complete confidence.

Bailey provides unique levels of safety in all of its motorhomes thanks to a crash-testing programme which the company has undertaken to ensure its vehicles can withstand the force of a head-on impact. As a result, Bailey motorhomes have the extra support of chassis outriggers to strengthen floors, more robust fittings to secure heavy appliances such as ovens and fridges, plus steel-framed seat base supports for all designated travel seats. With ABS (Anti-lock braking system), ESP (Electronic Stability Programme), TPMS (Tyre Pressure Monitoring System) as well as driver and passenger airbags also part of the standard specification the Adamo can justifiably claim to be one of the safest leisure vehicles available today.

As with all Bailey leisure vehicles models are built using our patented Alu-Tech construction technology, cloaked in a GRP outer skin, making them more robust, more durable and yet lighter than those manufactured using conventional methods to offer greater protection against the elements to keep you comfortable, safe and secure all year round. To date approaching 65,000 Bailey leisure vehicles have been built with this ground-breaking technology and are currently being used around the world.

Adamo models are fitted with a fully specified Truma Combi heating and hot water system which allows you to holiday no matter the time of year. Combined with the market-leading thermal



PRESS RELEASE

ISSUE DATE: 25/09/2020

EMBARGO DATE: 25/09/2020

REFERENCE NO: 200921

characteristics of the Alu-Tech body shell, this makes this a genuine all-weather vehicle, a fact confirmed with the achievement of the highest rating for thermal performance (Grade III Classification of EN1656-I) in rigorous cold chamber testing.

Providing you with more motorhome for your money Adamo includes many features normally only found on the optional extras list of comparable vehicle ranges as standard fitment. A Truma 80 watt solar panel provide the opportunity for genuine 'off-grid' holidays. Fully-equipped kitchens featuring a Thetford 'K-Series' combination oven, grill and dual-fuel hob (with 3 gas burners & 1 electric hotplate) plus a Thetford 142 litre tower refrigerator, include everything you will need to create your favourite meals. Whilst the Status 550 telescopic digital TV aerial and a multi-directional slide out TV bracket (model specific) provide the basis for a relaxing evening's entertainment after a day of adventure.

Models from the new Adamo line up will start arriving on Retailer forecourts from late September onwards.

Please visit baileyofbristol.co.uk for more information about the Bailey product ranges, to download a product brochure and to find your nearest Bailey Retailer. For the latest Bailey news, please follow Bailey on either Facebook [@Baileycaravansandmotorhomes](https://www.facebook.com/Baileycaravansandmotorhomes), Twitter [@BaileyofBristol](https://twitter.com/BaileyofBristol) or Instagram [@BaileyofBristol](https://www.instagram.com/BaileyofBristol).



New Adamo motorhome featuring Ford chassis and cab with automatic transmission gearbox



PRESS RELEASE

ISSUE DATE: 25/09/2020

EMBARGO DATE: 25/09/2020

REFERENCE NO: 200921



Adamo 69-4 garage comes with 230v and 12v power supply, heating outlet, six lashing rings and hanging rail with drainage for wet items



Adamo 69-4 featuring standard 'Odyssey' soft furnishings



Adamo Flexi lounge featuring twin Aguti convertible travelling seats and electric pedestal table



Adamo 75-41 kitchen with Thetford 'K-Series' combined oven, grill and hob



Adamo 69-4 bathroom



Adamo 75-41 bedroom



Adamo 75-4DL rear lounge

Notes to editors:

- The Bailey of Bristol website contains full details of its caravan and motorhome ranges as well as all the latest company news and information: baileyofbristol.co.uk
- Founded in 1948, Bailey of Bristol is the longest established UK independent manufacturer with over 70 years' experience in leisure vehicle production and design. During this period our family-owned business has grown to become not only the manufacturer of the UK's most popular caravan brand, but also one of the largest in Europe. In 2011, the company brought this same level of expertise to the motorhome world, as well as expanding to new export markets in Australia, New Zealand and South Korea.
- With more Bailey leisure vehicles on the road in the UK than any other, our company has earned its place as The Nation's Favourite. The signature build quality, comprehensive specification and superb value for money combine to set us apart from the competition and will ensure people will continue to 'Go Bailey' for many years' to come.
- Ten years' ago the company introduced the Alu-Tech body shell construction system, which is seen by most observers as the most significant development in leisure vehicle production technology for three decades. Providing genuine design innovation, this fully patented technology means that Bailey leisure vehicles are now some of the best



PRESS RELEASE

ISSUE DATE: 25/09/2020

EMBARGO DATE: 25/09/2020

REFERENCE NO: 200921

engineered and most technically advanced on the market, keeping owners comfortable, safe and secure, no matter how tough the conditions.

- freedomtogo.co.uk: As a leading UK manufacturer, Bailey of Bristol is a keen supporter of the 'Freedom to Go' campaign developed by the caravan and motorhome industry to help people discover and plan their next adventure or relaxing escape. It offers inspiring ideas on where to go on holiday, and what to do when you get there, plus helpful advice, such as comparing whether a caravan or motorhome is the right and affordable choice.